

## AGREEMENT

THIS AGREEMENT made and entered into this 6<sup>th</sup> day of Feb., 1980, by and between the Silver Lake Water District, a municipal corporation of the State of Washington, hereinafter referred to as the "District," and the City of Everett, a municipal corporation of the State of Washington, hereinafter called the "City," and hereto agree as follows:

1. The City is in the process of installing an 8" water supply main on 19th Avenue S.E. at the sole expense of the City. In consideration of the other provisions herein, the City hereby grants to Silver Lake Water District the right to make connections to the said new 8" water main at its own cost which connections will be metered and the cost of water will be added to the total bill for metered water payable by the District to the City each month. The District agrees to follow the rules, regulations and ordinances of the City of Everett regarding installation, maintenance and operation of said connections.

2. In consideration for access to the new 8" main, the District will abandon all customers and laterals and mains in the area south of 100th Street S.W., east of 3rd Avenue S.E., west of I-5, and north of the City limits at about 107th Street S.E. (Exhibit "A" on attached map). Further, upon annexation of the District's area north of 112th Street, west of I-5 and south of the area described above to the City, the District agrees to abandon all customers, laterals and mains in this area (Exhibit "B" on attached map). By assuming said mains and laterals and servicing and billing the customers within the said area, the City shall not be liable for payment of any pro-rata share of the District's bonded indebtedness. The District's right of access to the new 8" main shall be the District's sole consideration for the City's undertaking services and customers and maintaining the laterals and mains in that area.

3. As part of this Agreement, the District will abandon its existing main on 19th Avenue S.E.; provided that the cost of reconnecting any existing services or new services to the new 8" main for the District's customers shall be borne by the District in accordance with the terms of this Agreement.

CITY OF EVERETT

  
WILLIAM E. MOORE  
Mayor

ATTEST:

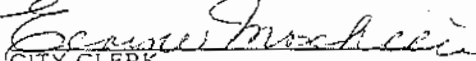
  
CITY CLERK

APPROVED AS TO FORM:

  
CITY ATTORNEY

SILVER LAKE WATER DISTRICT

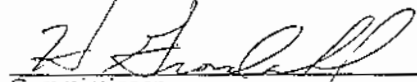
  
Commissioner

Commissioner

  
Commissioner

ATTEST:

  
SECRETARY

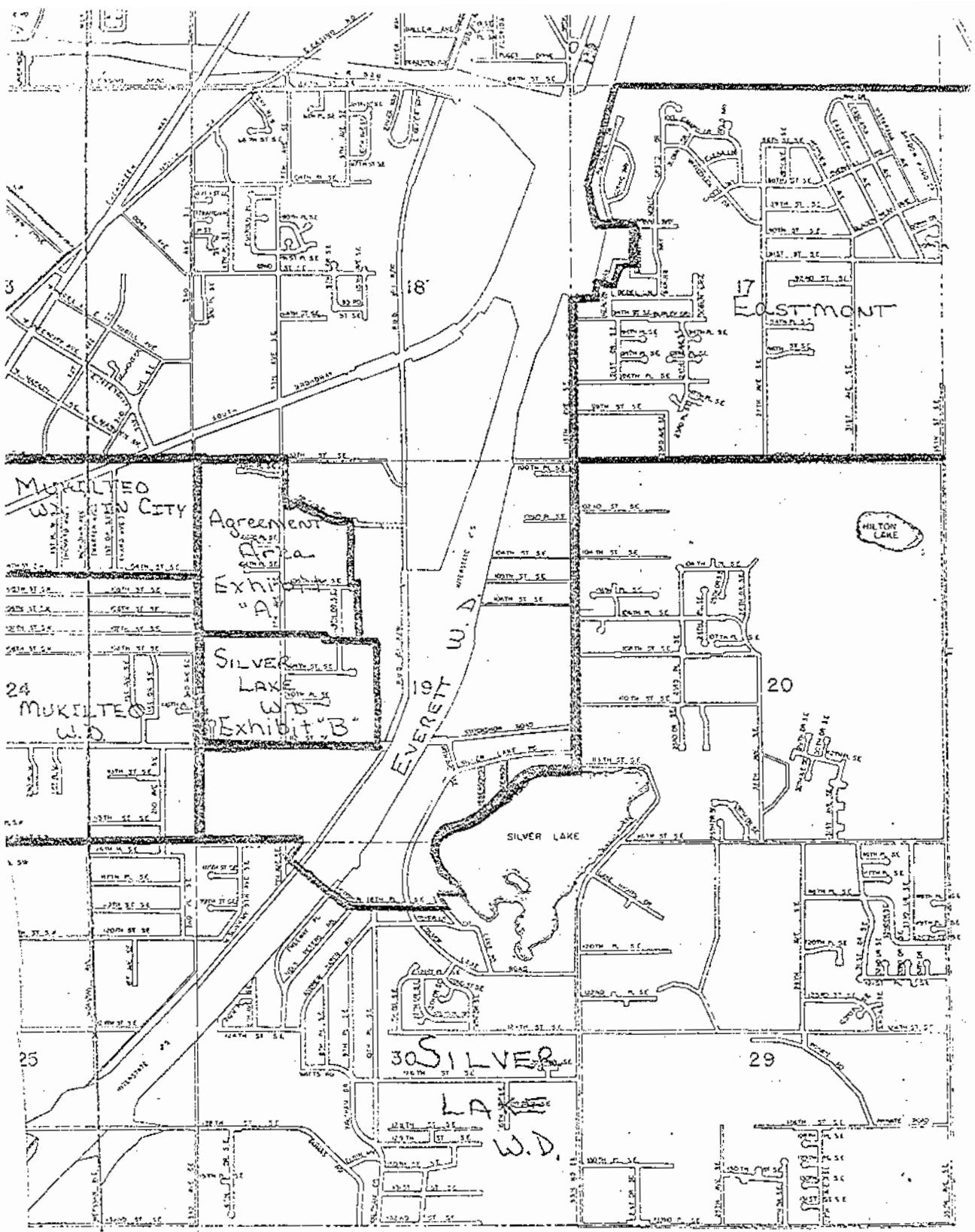

3

17 EASTMONT

MUKILTEO W.D. CITY

Agreement

Exhibit "A"

SILVER LAKE W.D.

Exhibit "B"

24 MUKILTEO W.D.

20

EVERETT W.D.

SILVER LAKE

25

30 SILVER LAKE W.D.

29